

- GENERAL NOTES**
1. Compaction of embankments shall be accomplished by any satisfactory method approved by the project engineer. The contractor shall use mechanical tampers.
 2. If no satisfactory method of compacting loose material is found, then embankment shall be stacked earth filled sacks or concrete rip-rap.
 3. All concrete revetment shall be 6A4000 concrete.
 4. Unless otherwise approved and directed by the engineer a granular foundation shall be used conforming to section 1001-9. The cost for installing the granular foundation will be at no direct pay.
 5. Top of lining to be adjusted if necessary to match existing ground.
 6. Reinforcing steel, wire mesh and joint material used in ditch pavement to be included in price bid for concrete revetment.
 7. Contractor shall dispose of excess excavation outside limits of the project. Cost to be included in price bid for channel excavation.
 8. Existing wingwalls, retaining wall and revetment to be removed as shown on plans.
 9. Borrow material, where req'd, shall consist of select material (A-4 or better) to be placed at locations warranted and as directed by project engineer.
 10. If silty material is encountered in the side slopes of the channel section, and if so directed by the engineer, sets of weep holes shall be installed transversely across the channel rather than longitudinally down the channel. The total number of weep holes so installed shall not exceed the number that would otherwise have been installed in a longitudinal manner.
 11. Expansion joint seal: prime all surfaces with 2379 primer (Grace material) or equal, allow one hour for drying time. Apply vertiseal coat 2381 (Grace material) or equal.
 12. All fence posts to be set prior to installing toe wall & sidewalk. (See 704-07).
 13. Flowable Fill shall conform to the requirements as specified in the contract special provisions. Prior to placement removable wooden plugs shall be installed in weep holes, and temporary enddams or soil berms shall be placed as necessary to confine the flowable fill. Flowable fill shall be vibrated during placement to assure all voids are filled.
 14. Where pumping is necessary for placement of flowable fill, pumping rate shall be controlled to the extent necessary to prevent movement, collapse or floatation of existing concrete panels. For long slopes where high hydraulic pressures will be generated flowable fill must be placed in lifts with a minimum of six (6) hours between lifts to allow previous lift time to stiffen.
 15. Required 6x6x6/6 welded wire mesh fabric shall conform to either ASTM A185 or ASTM A497. Welded wire mesh fabric shall only be furnished in flat sheets, rolls will not be accepted. Welded wire fabric shall be placed in accordance with detail by utilizing approved bar chairs or other approved methods.

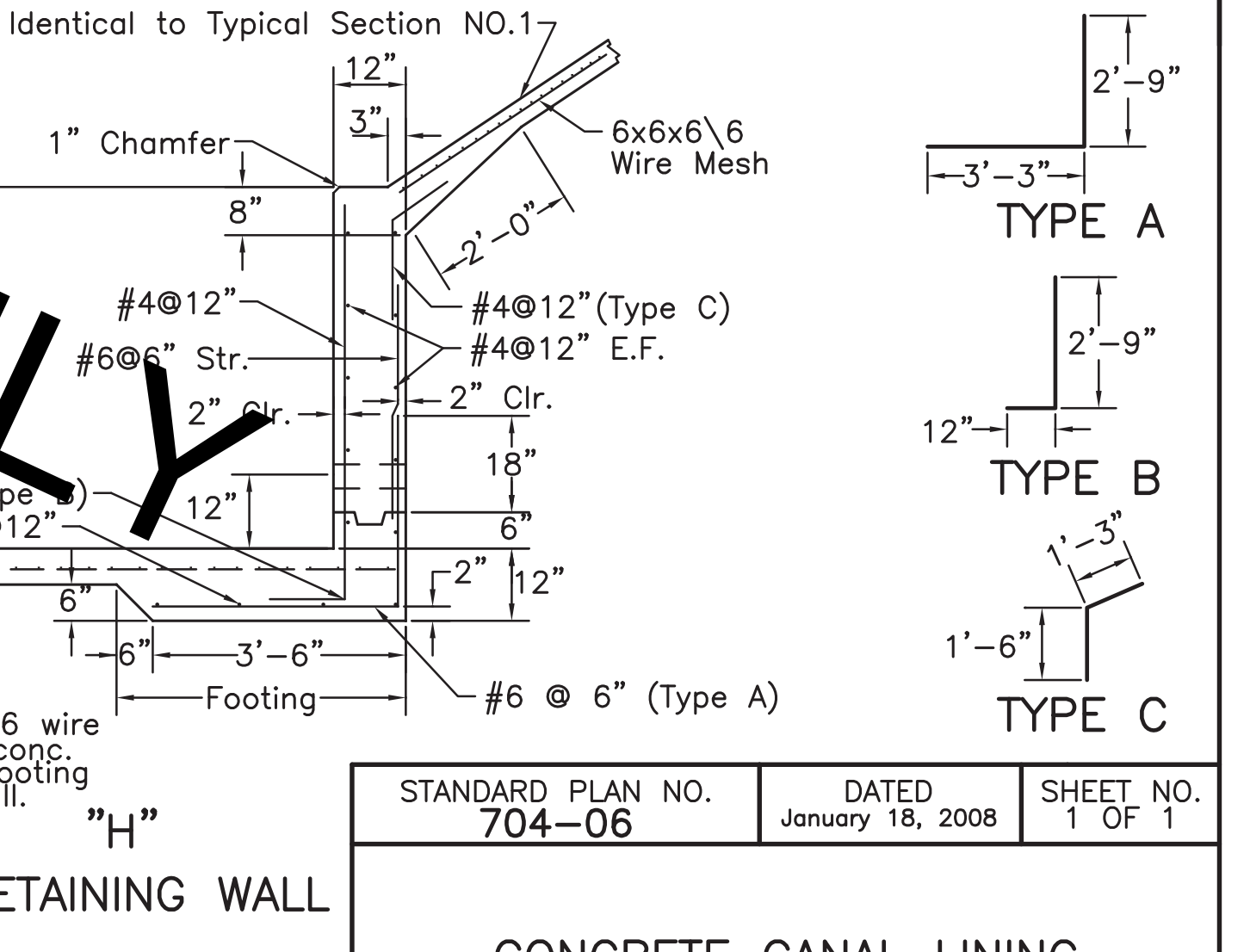
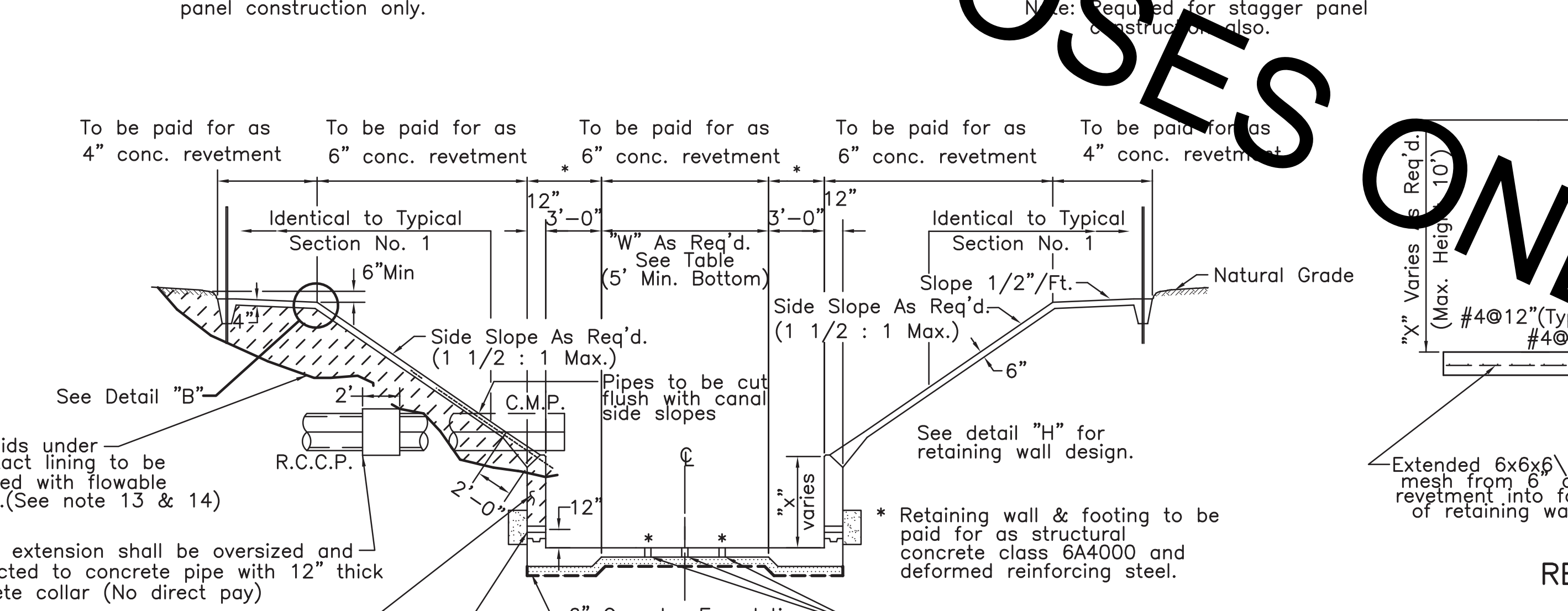
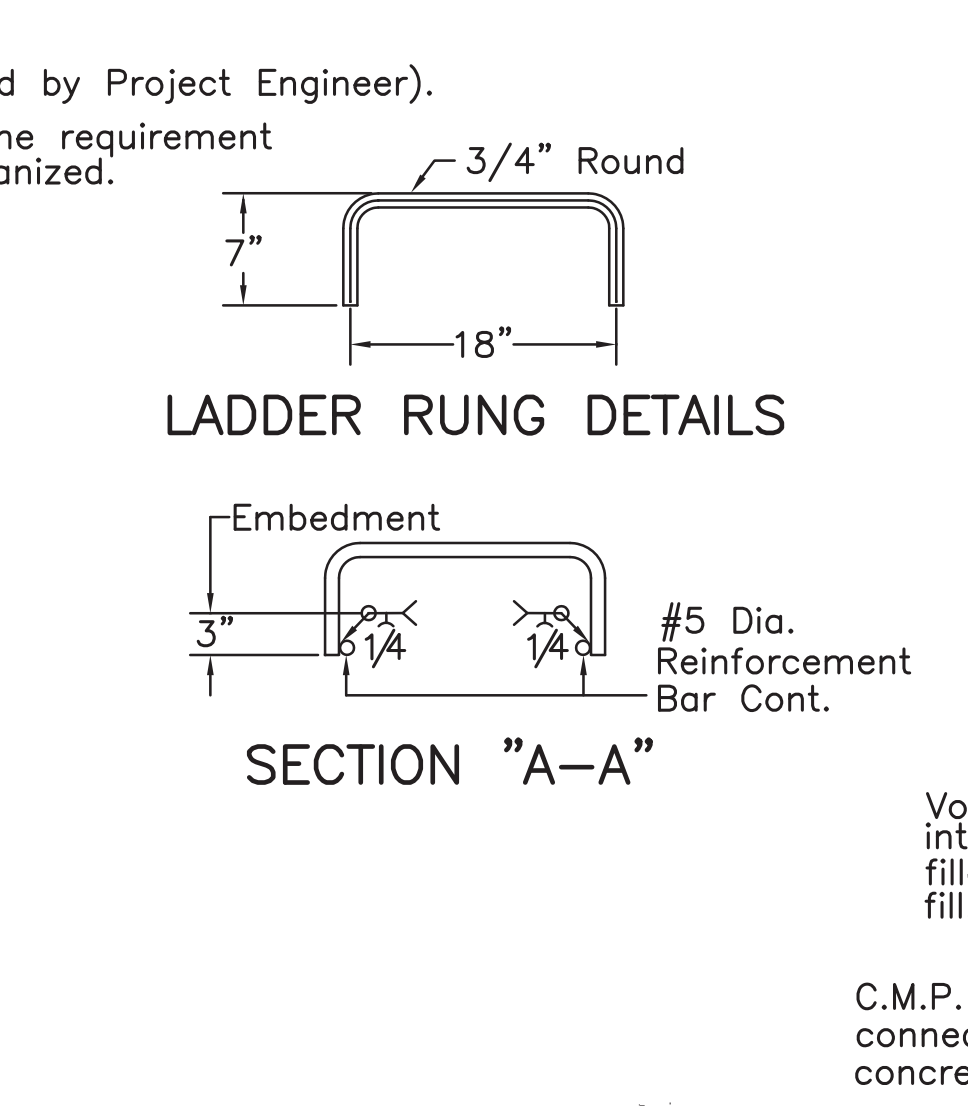
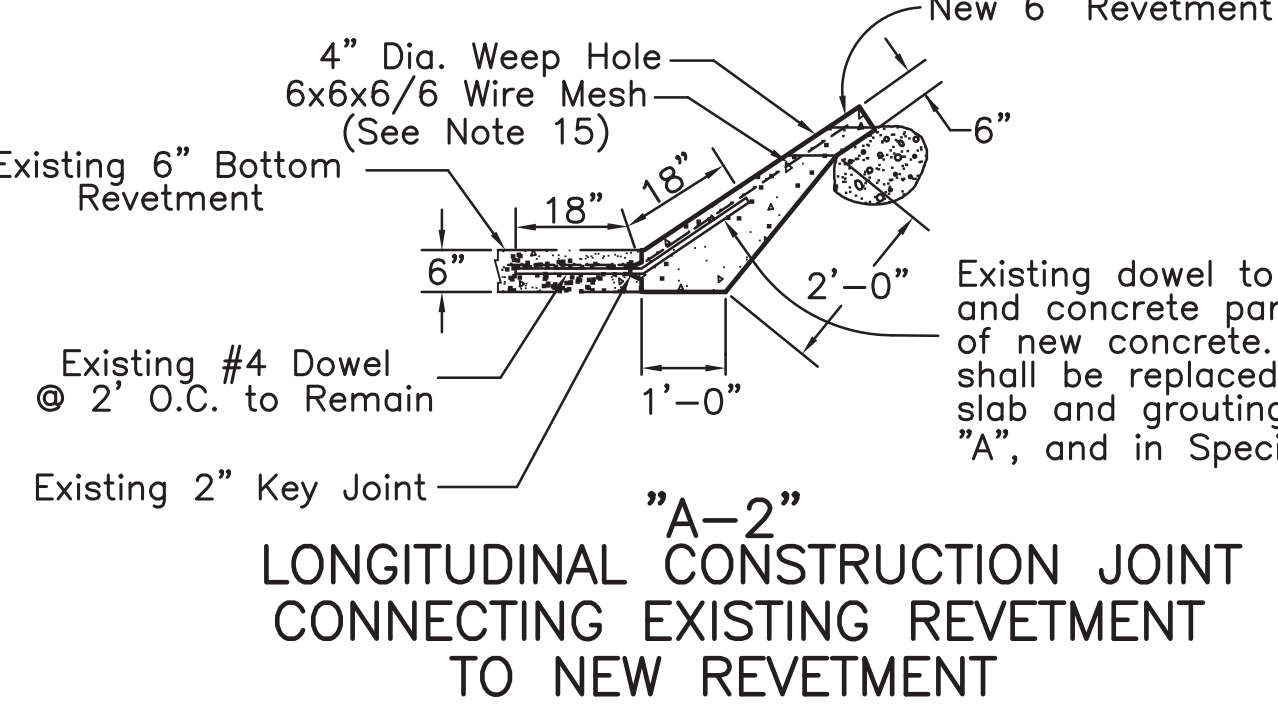
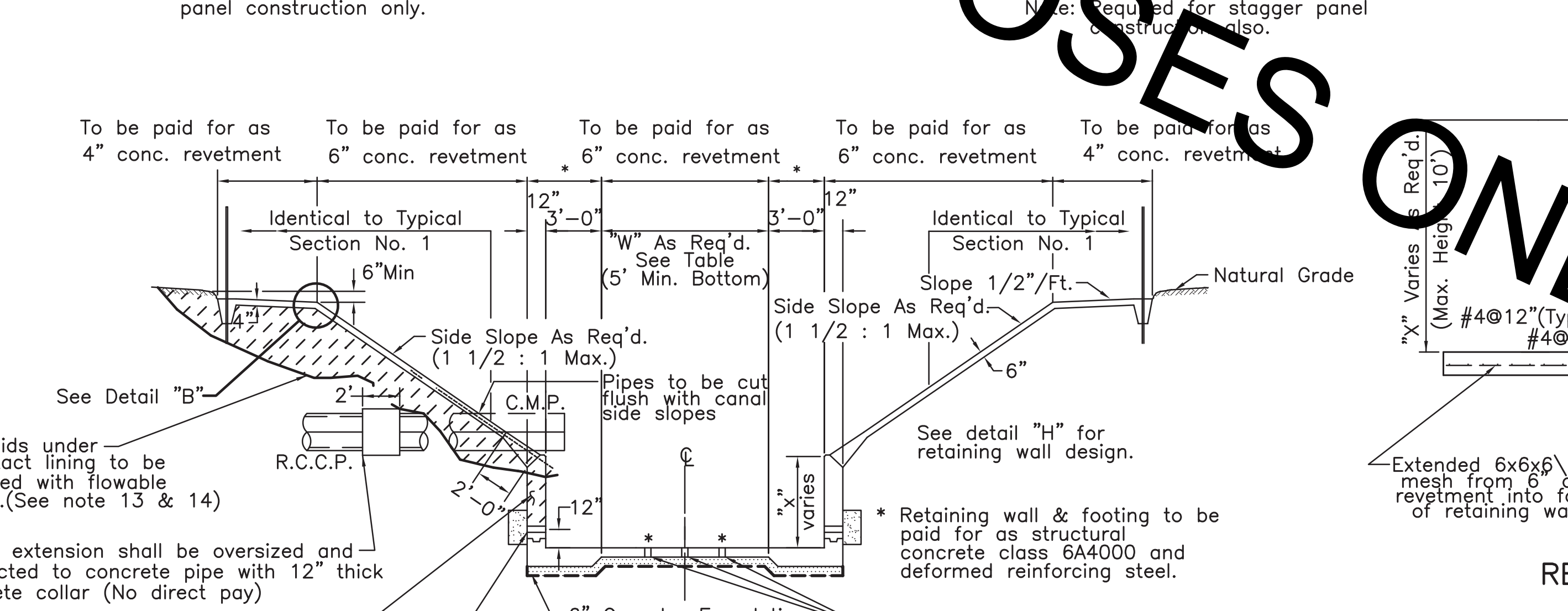
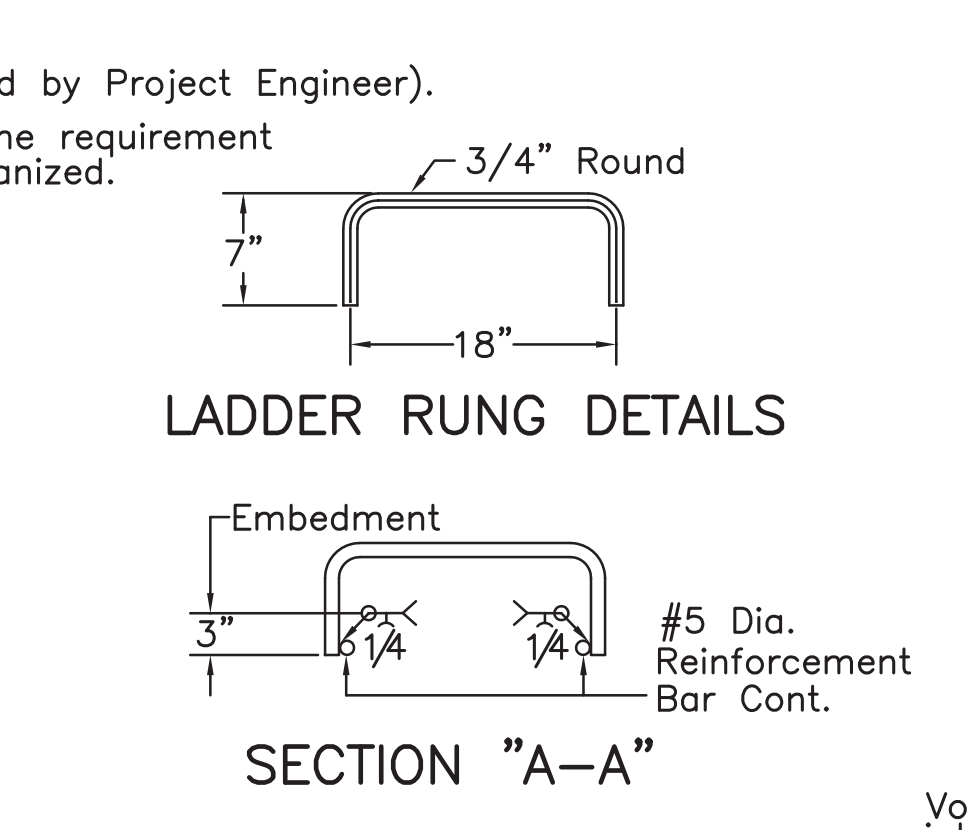
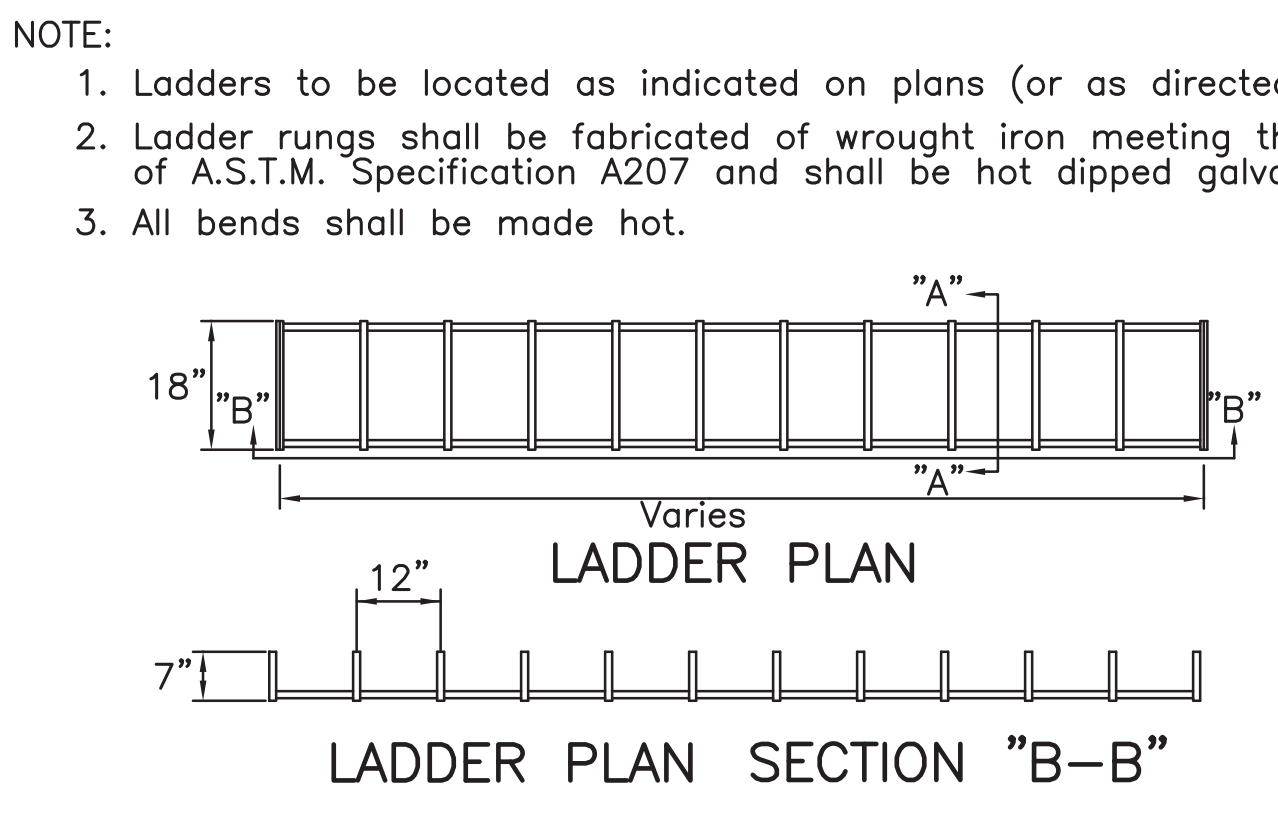
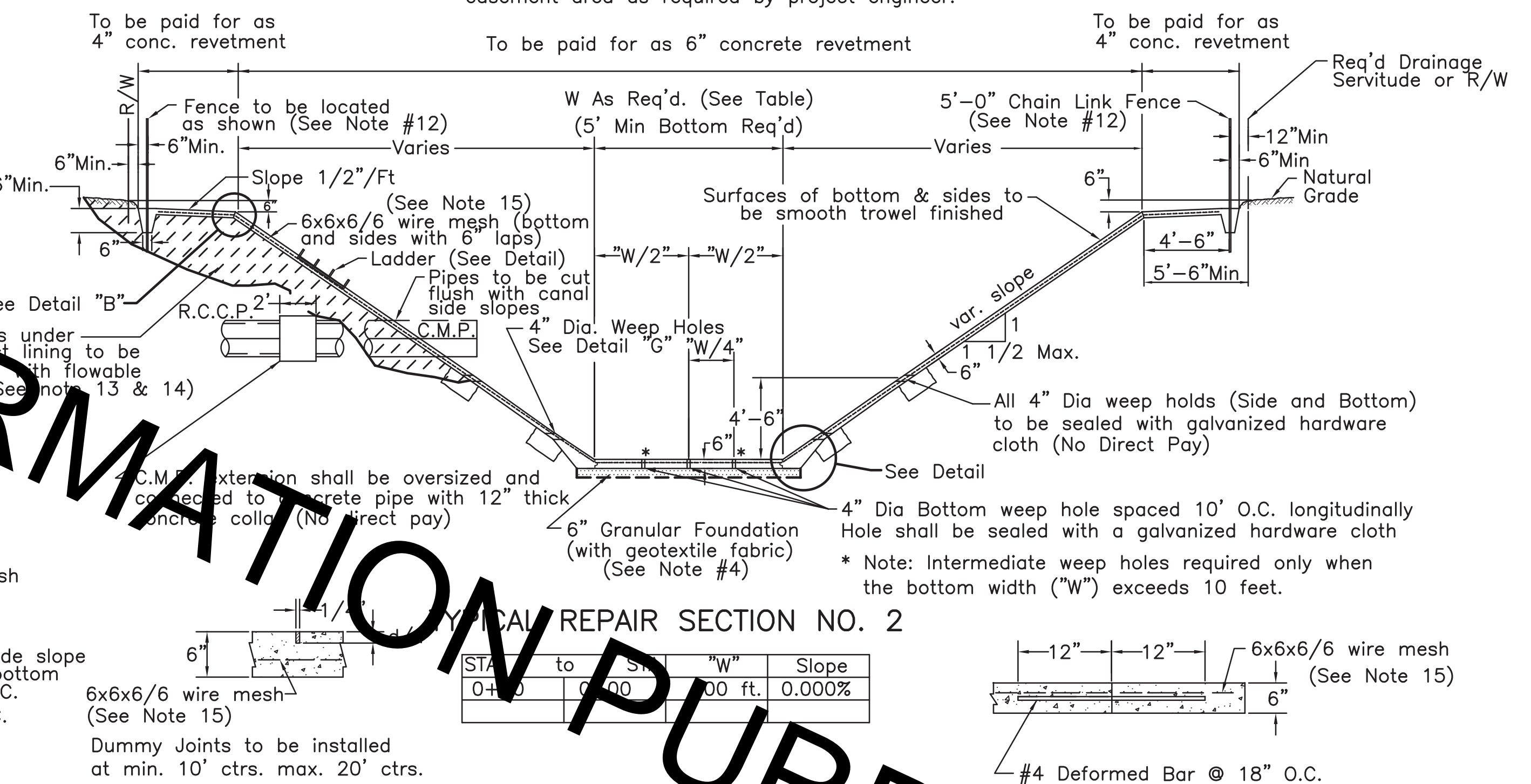
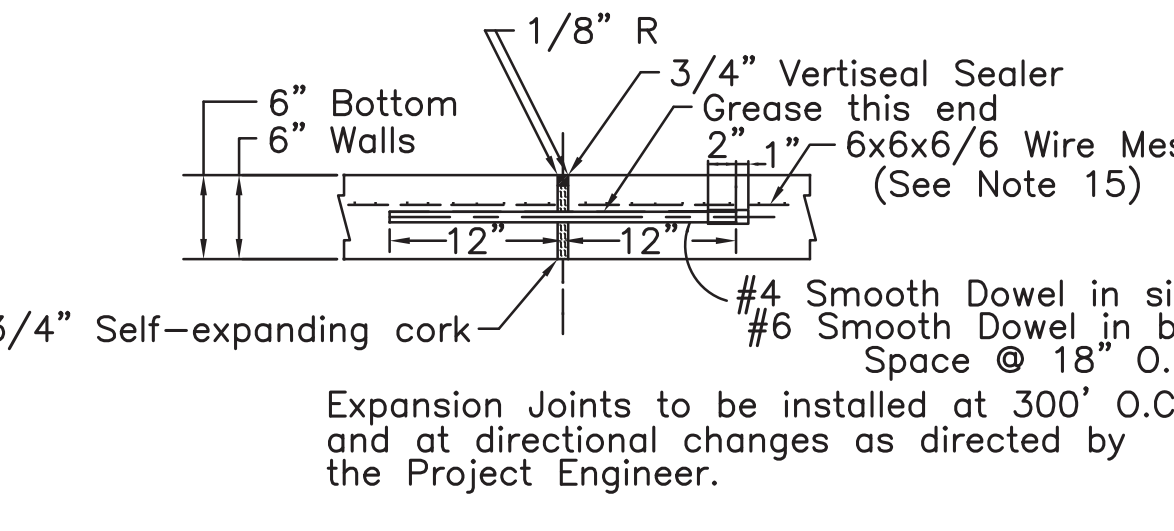
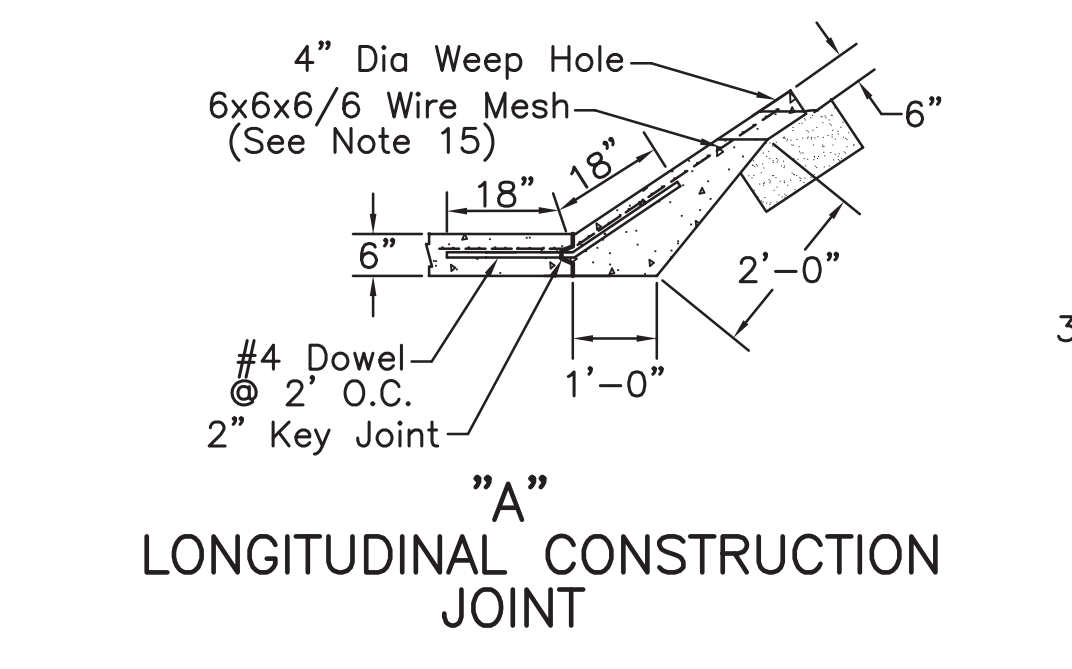
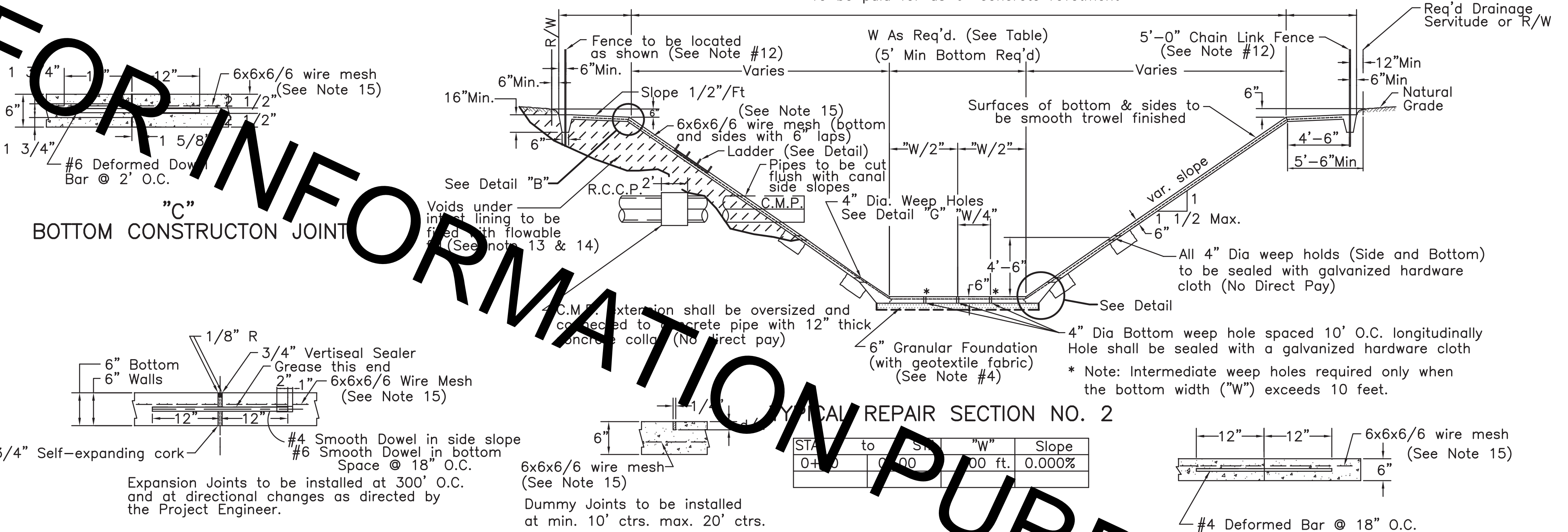
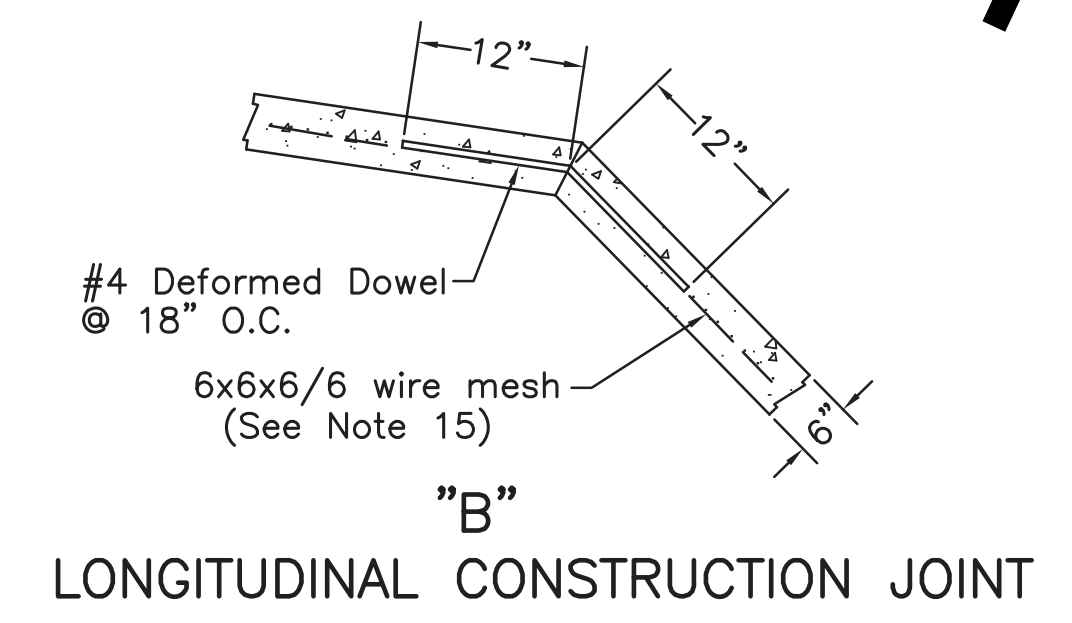

THOMAS A. STEPHENS
LICENSED PROFESSIONAL ENGINEER
IN THE STATE OF LOUISIANA
3/16/2018

STA.	to	STA.	"W"	Slope
0+00	0+00	00 ft.	0.000%	

DATE	DESCRIPTION	BY
	REVISIONS	

STANDARD PLAN NO. 704-06	DATED January 18, 2008	SHEET NO. 1 OF 1
CONCRETE CANAL LINING DETAILS CONCRETE CANAL LINING REPAIRS		
ENGINEERING DIVISION DEPARTMENT OF PUBLIC WORKS CITY OF BATON ROUGE & PARISH OF EAST BATON ROUGE		
DESIGNED J.M. KLIER	DRAWN D.R. PATT	CHECKED B. HARMON
		APPROVED T. STEPHENS