

PROJECT NO.	SHEET

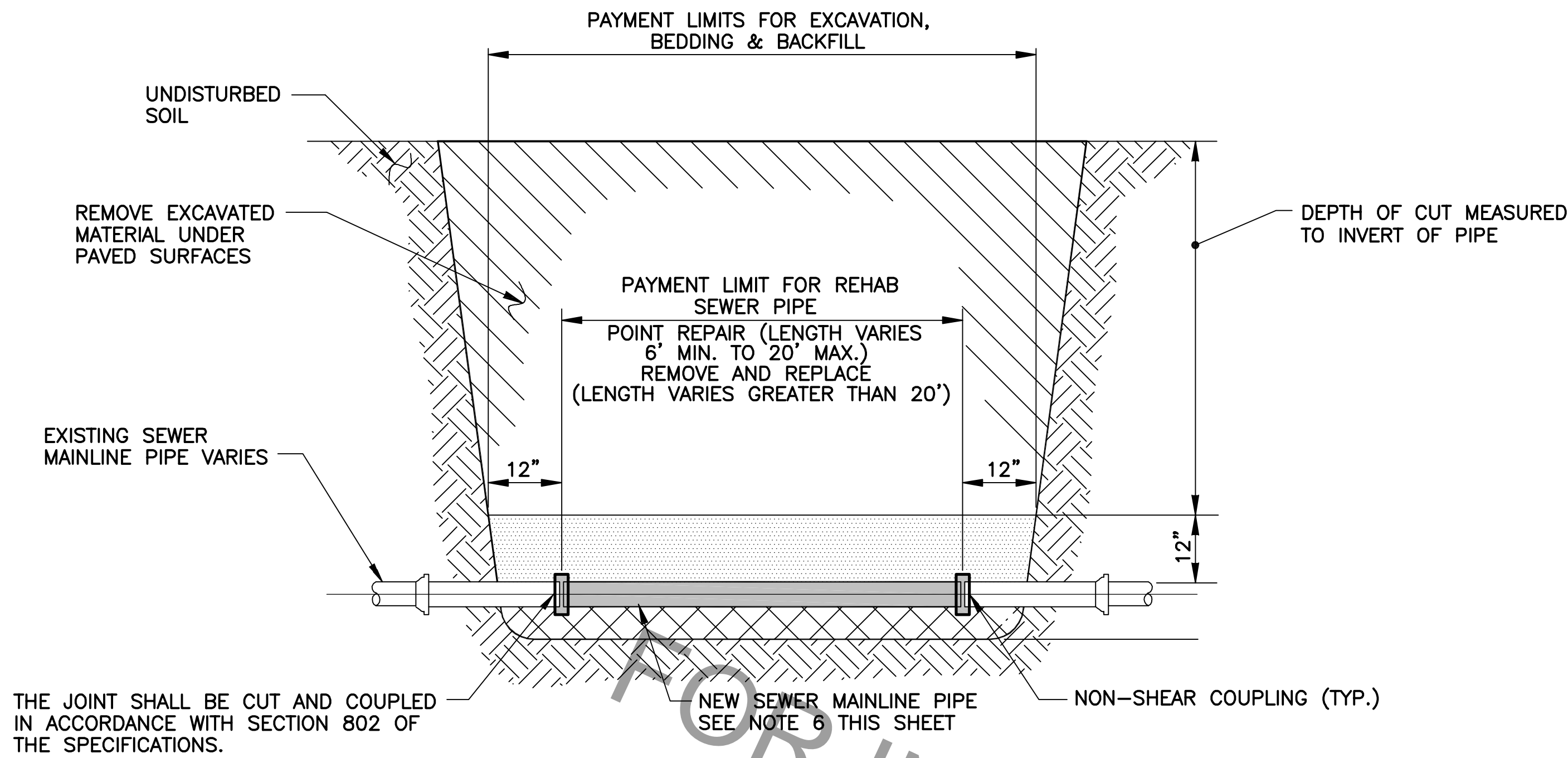

STANDARD TYPICAL SEWER
PIPE REPLACEMENT AT MID SEGMENT

N.T.S.

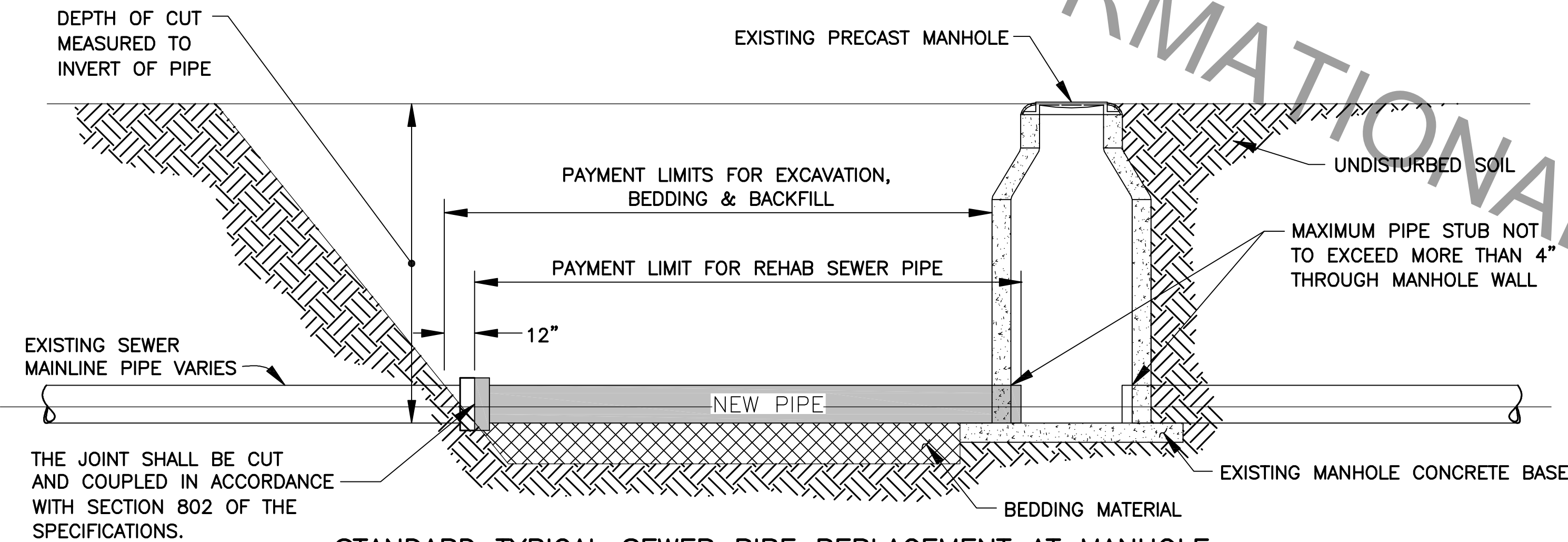

STANDARD TYPICAL SEWER PIPE REPLACEMENT AT MANHOLE

N.T.S.

NOMINAL PIPE DIA. (INCHES)	MINIMUM GRADE (%)	MAX. ALLOWABLE SAG DEPTH (D)* IN INCHES OF WATER EQUAL OR LESS THAN MINIMUM GRADE	MAXIMUM SAG LENGTH (L)**	MIN. ALLOWABLE DIST. BETWEEN SAGS W/ 10% OR GREATER DEPTH (X)***
8	0.400	0.8"	6 FT	36 FT
10	0.280	1"	6 FT	36 FT
12	0.220	1.1"	9 FT	54 FT
15	0.150	1.5"	9 FT	54 FT
16	0.140	1.5"	9 FT	54 FT
18	0.120	1.5"	9 FT	72 FT
21	0.100	1.5"	9 FT	72 FT
24	0.080	1.5"	9 FT	72 FT
27	0.067	2"	9 FT	72 FT
30	0.058	2"	9 FT	72 FT
36	0.046	2"	9 FT	72 FT
42	0.037	2"	9 FT	72 FT

SANITARY SEWER GRADE TOLERANCE/
ACCEPTABLE SAG LIMITS

N.T.S.

*D = MAX. ALLOWABLE SAG DEPTH =ALLOWABLE DEPTH OF POOLED WATER AS MEASURED FROM WATER SURFACE TO INVERT OF PIPE BY USE OF SAG GAUGE.

**L = SAG LENGTH = LENGTH OF POOLED WATER SURFACE AS MEASURED FROM UPSTREAM EDGE OF POOLED WATER SURFACE TO DOWNSTREAM EDGE OF POOLED WATER SURFACE.

***X = DISTANCE BETWEEN SAGS, AS MEASURED FROM UPSTREAM EDGE OF POOLED WATER SURFACES BETWEEN CONSECUTIVES SAGS.

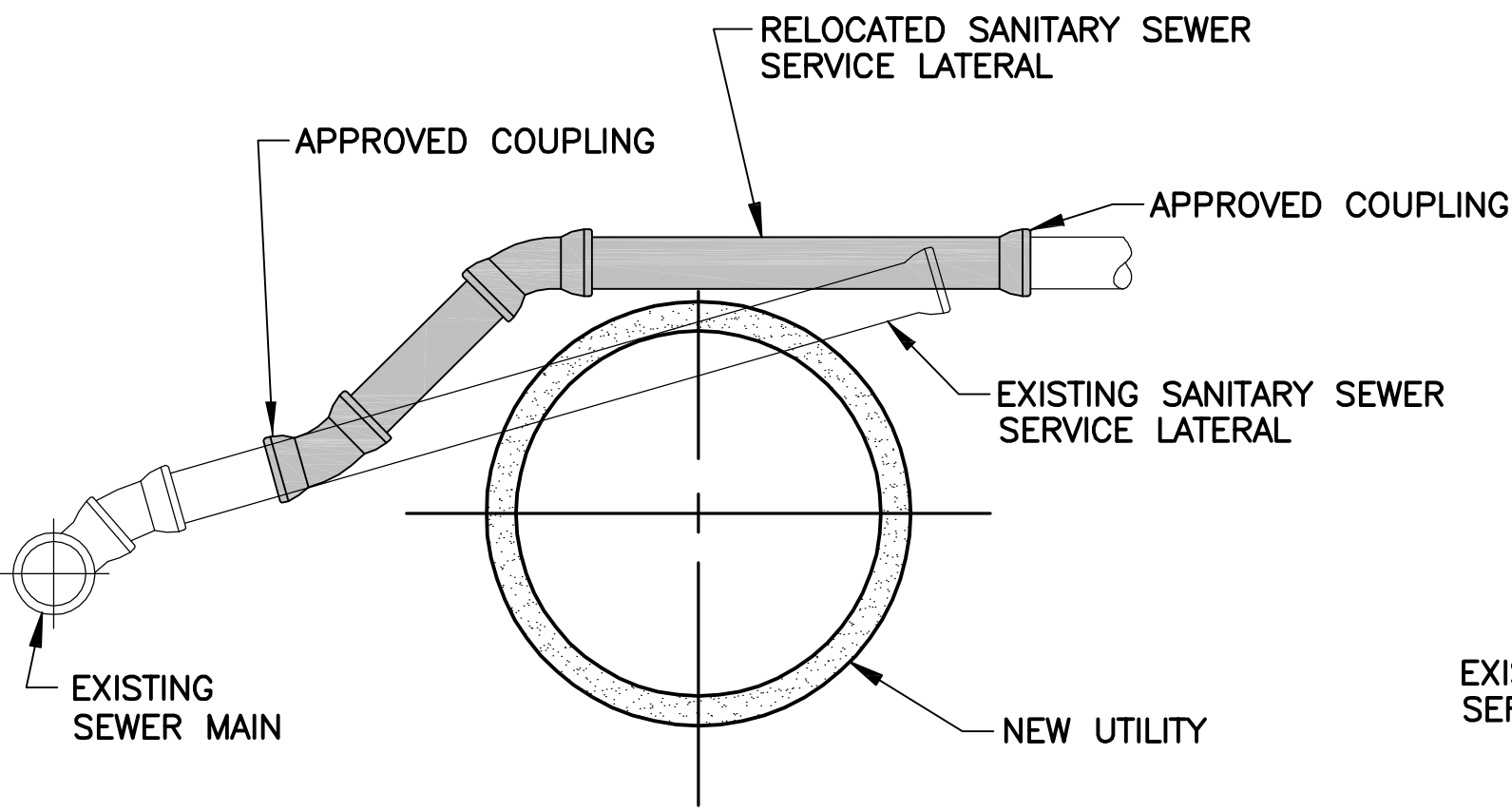
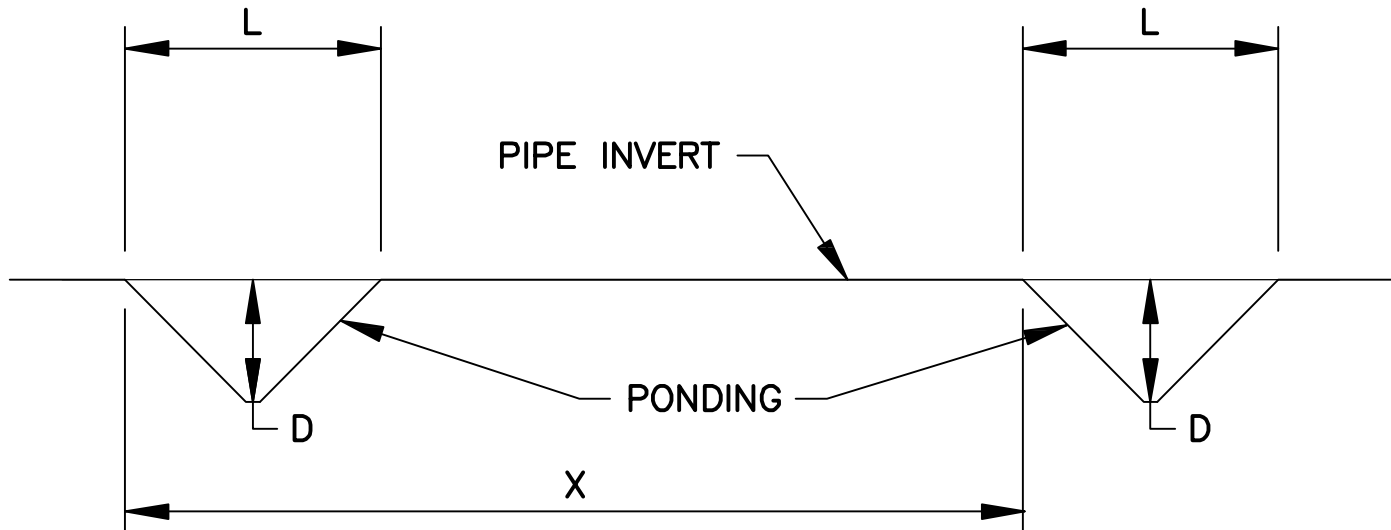

CASE "A"

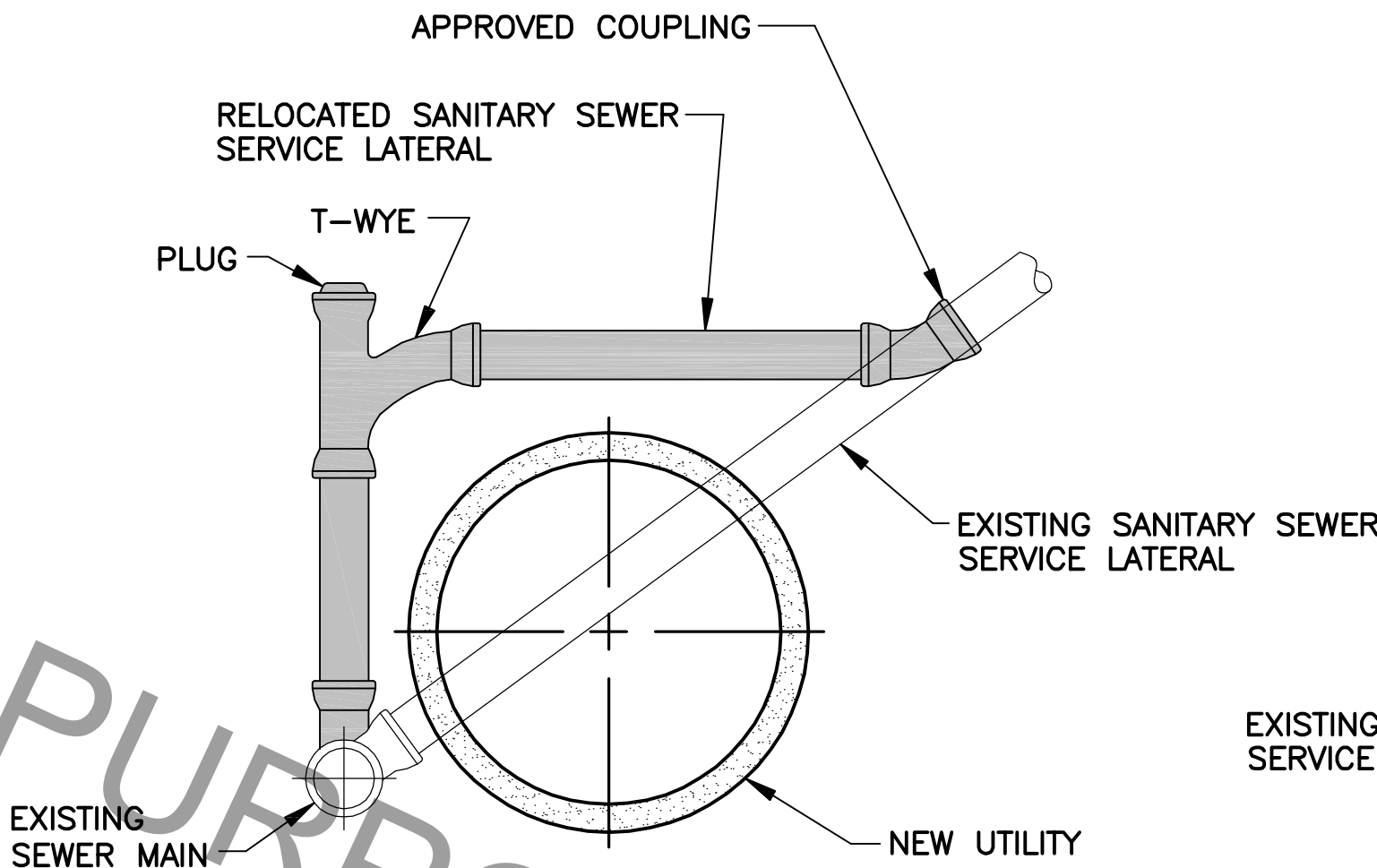

CASE "B"

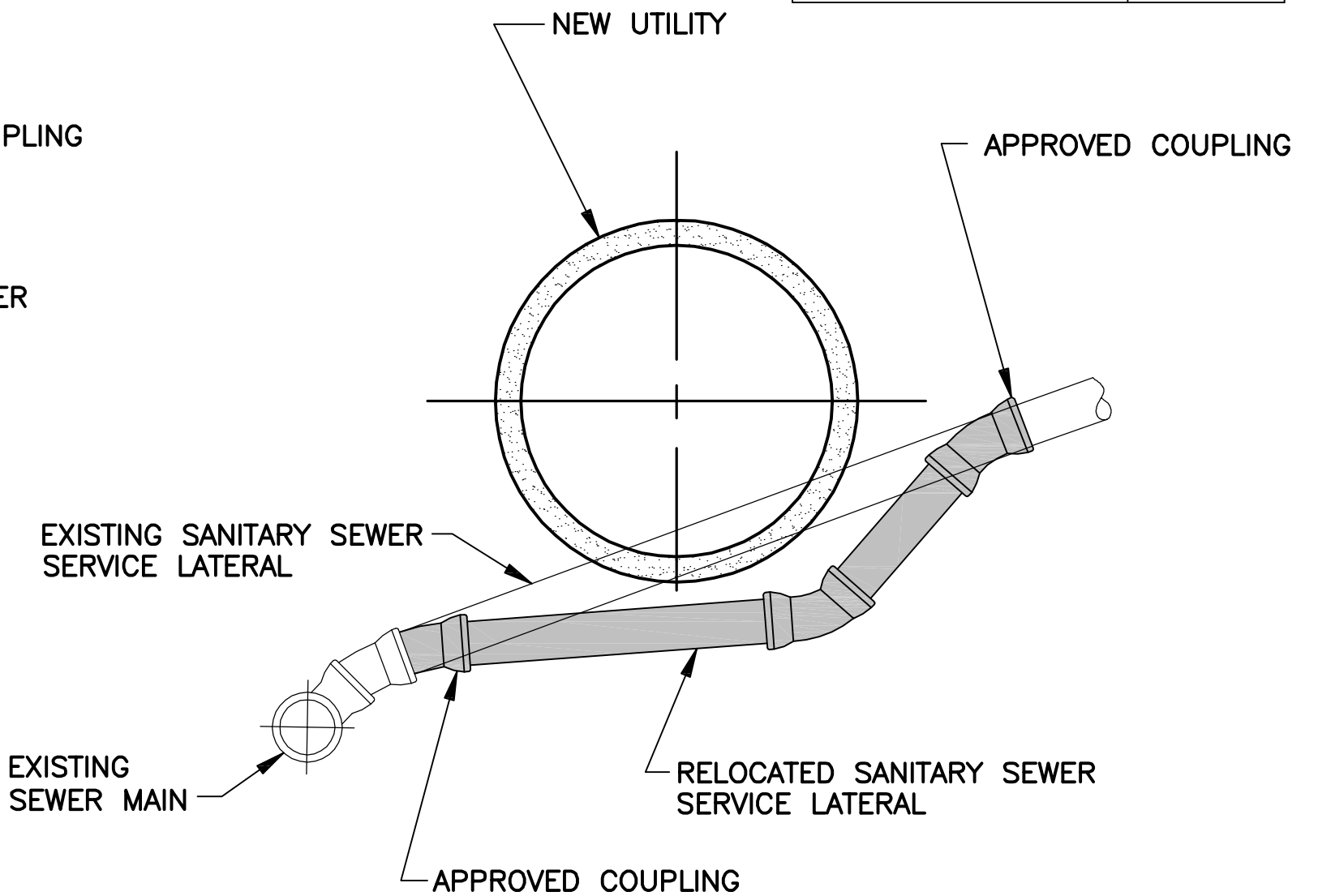

CASE "C"

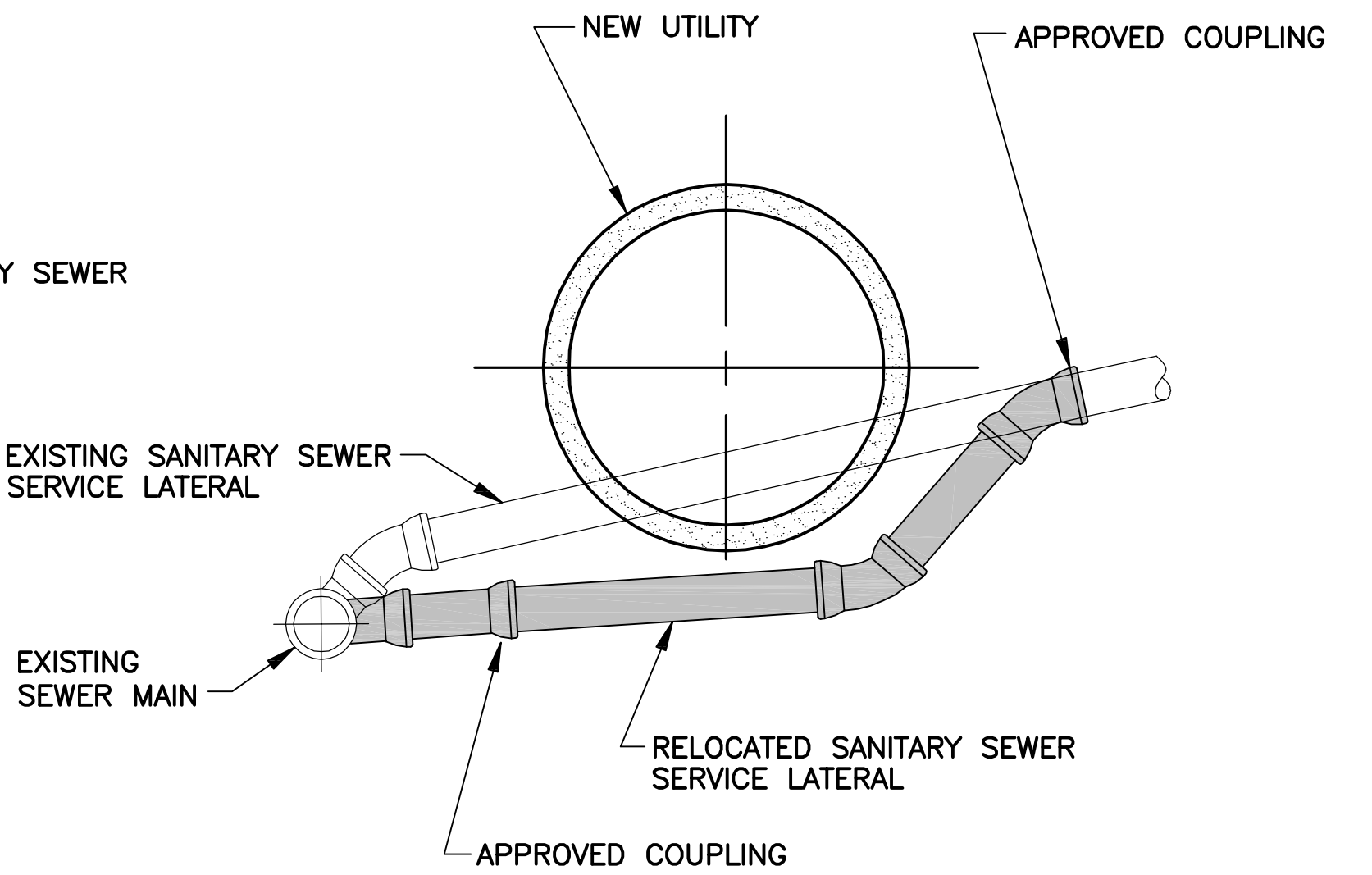

CASE "D"

LEGEND

- RELOCATED SANITARY SEWER SERVICE LATERAL
- EXISTING SANITARY SEWER SERVICE LATERAL

ADJUSTED SANITARY SEWER SERVICE
LATERAL CONNECTION DETAILS

N.T.S.

NOTES:

- THE RELOCATED SANITARY SEWER SERVICE LATERAL SHALL BE CONSTRUCTED OF POLYVINYL CHLORIDE (PVC) PIPE EXCEPT WHERE THE SANITARY SEWER SERVICE LATERAL IS BELOW THE UTILITY OR HAS LESS THAN 3 FEET OF COVER TO FINISH GRADE. IN THESE CASES THE PIPE MATERIAL SHALL BE DUCTILE IRON.
- THE RELOCATED SANITARY SEWER SERVICE LATERAL SHALL BE CONNECTED TO THE EXISTING PIPE WITH APPROVED NON-SHEAR COUPLINGS.
- USE OF CASE "D" TYPE REROUTING DEPENDS ON THE LEVEL OF FLOW (PRESENT AND FUTURE) WITHIN MAINLINE SEWER - SUBJECT TO CASE APPROVAL BY ENGINEER.
- MINIMUM SLOPE ON ANY REROUTED SEGMENT OF SANITARY SEWER SERVICE LATERAL TO BE 1.00%.
- NEW SEWER PIPE LENGTH & TYPE TO BE DEFINED BY ENGINEER.
- BEDDING, SECONDARY BACKFILL, INITIAL BACKFILL, AND SURFACE RESTORATION SHALL BE IN ACCORDANCE WITH SECTION 801 OF THE SPECIFICATION AND STANDARD PLAN 801-01.

DATE	DESCRIPTION	BY
6/17	ADDED SAG LIMIT DETAIL	AMS
7/16	REVISED NOTE 2 & DIMENSION	AMS
	REVISIONS	

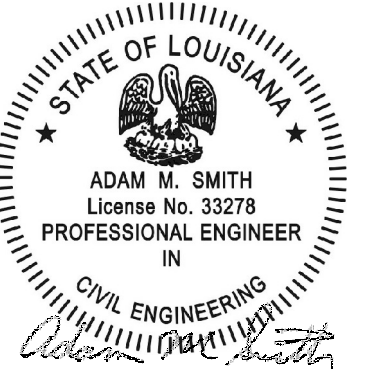

JUNE 28, 2017

STANDARD PLAN NO.	DATED	SHEET NO.
802-01	AUGUST 1, 2011	2 OF 2
SANITARY SEWER PIPE AND CLEANOUT DETAILS		
ENGINEERING DIVISION DEPARTMENT OF PUBLIC WORKS CITY OF BATON ROUGE & PARISH OF EAST BATON ROUGE		
DESIGNED	DRAWN	CHECKED
A. SCHULZE	G. VANNICE	N. COBB
		APPROVED
		A. SMITH