

PROJECT NO.	SHEET

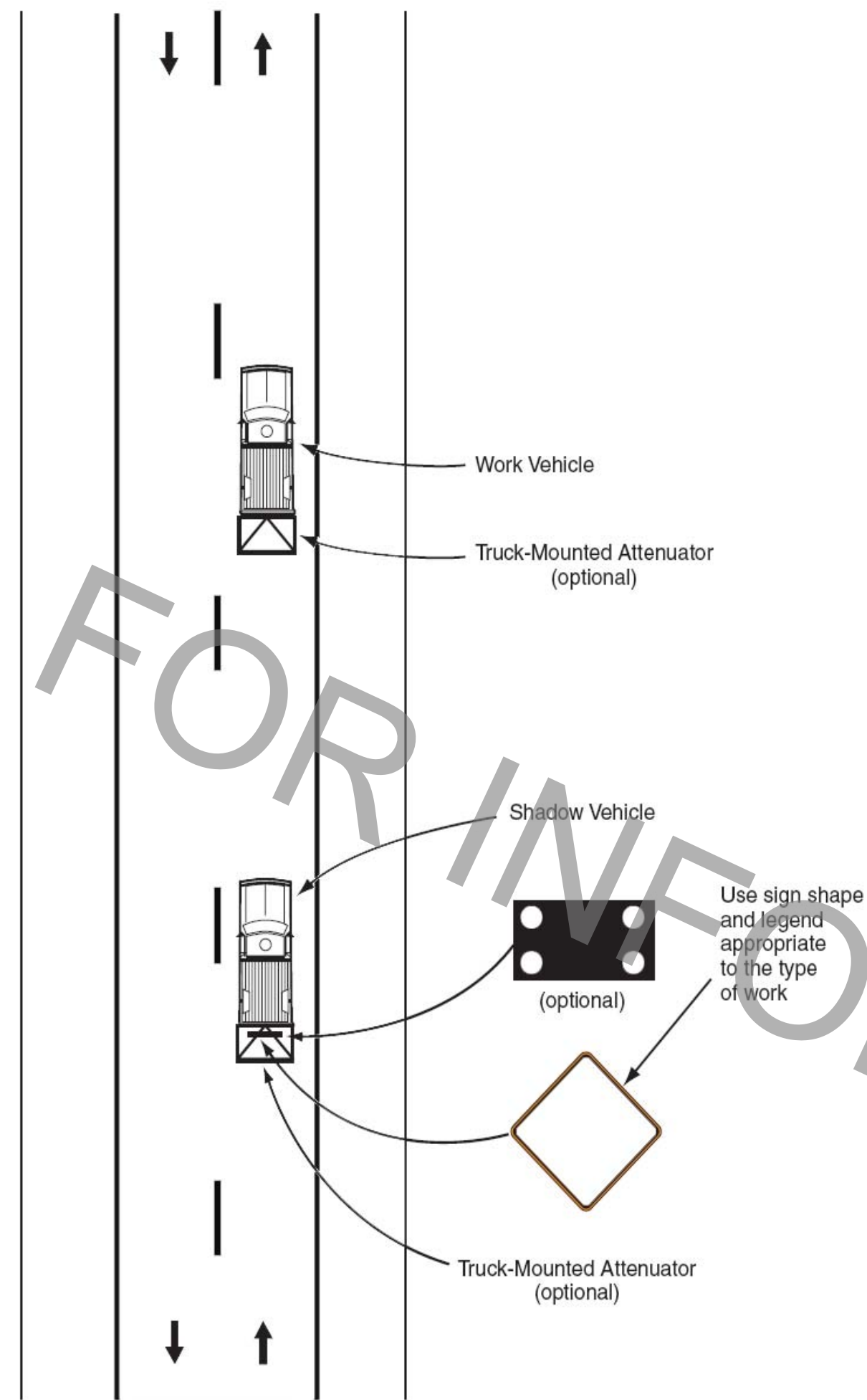

Figure TA-17  
Mobile Operations on Two-Lane Road

Notes:

1. Vehicle-mounted signs shall be mounted in a manner such that they are not obscured by equipment or supplies. Sign legends on vehicle-mounted signs shall be covered or turned from view when work is not in progress.
2. Shadow and work vehicles shall display high-intensity rotating, flashing, oscillating, or strobe lights.
3. If an arrow panel is used, it shall be used in the caution mode.
4. Where practical and when needed, the work and shadow vehicles should pull over periodically to allow vehicular traffic to pass.
5. Whenever adequate stopping sight distance exists to the rear, the shadow vehicle should maintain the minimum distance from the work vehicle and proceed at the same speed. The shadow vehicle should slow down in advance of vertical or horizontal curves that restrict sight distance.
6. The shadow vehicles should also be equipped with two high-intensity flashing lights mounted on the rear, adjacent to the sign.
7. The distance between the work and shadow vehicles may vary according to terrain, paint drying time, and other factors.
8. Additional shadow vehicles to warn and reduce the speed of oncoming or opposing vehicular traffic may be used. Law enforcement vehicles may be used for this purpose.
9. A truck-mounted attenuator may be used on the shadow vehicle or on the work vehicle.
10. If the work and shadow vehicles cannot pull over to allow vehicular traffic to pass frequently, a DO NOT PASS sign may be placed on the rear of the vehicle blocking the lane.
11. Shadow vehicles are used to warn motor vehicle traffic of the operation ahead.
12. Vehicle hazard warning signals shall not be used instead of the vehicle's high-intensity rotating, flashing, oscillating, or strobe lights.

This sheet shall be used with Standard Plan No. 905-01.

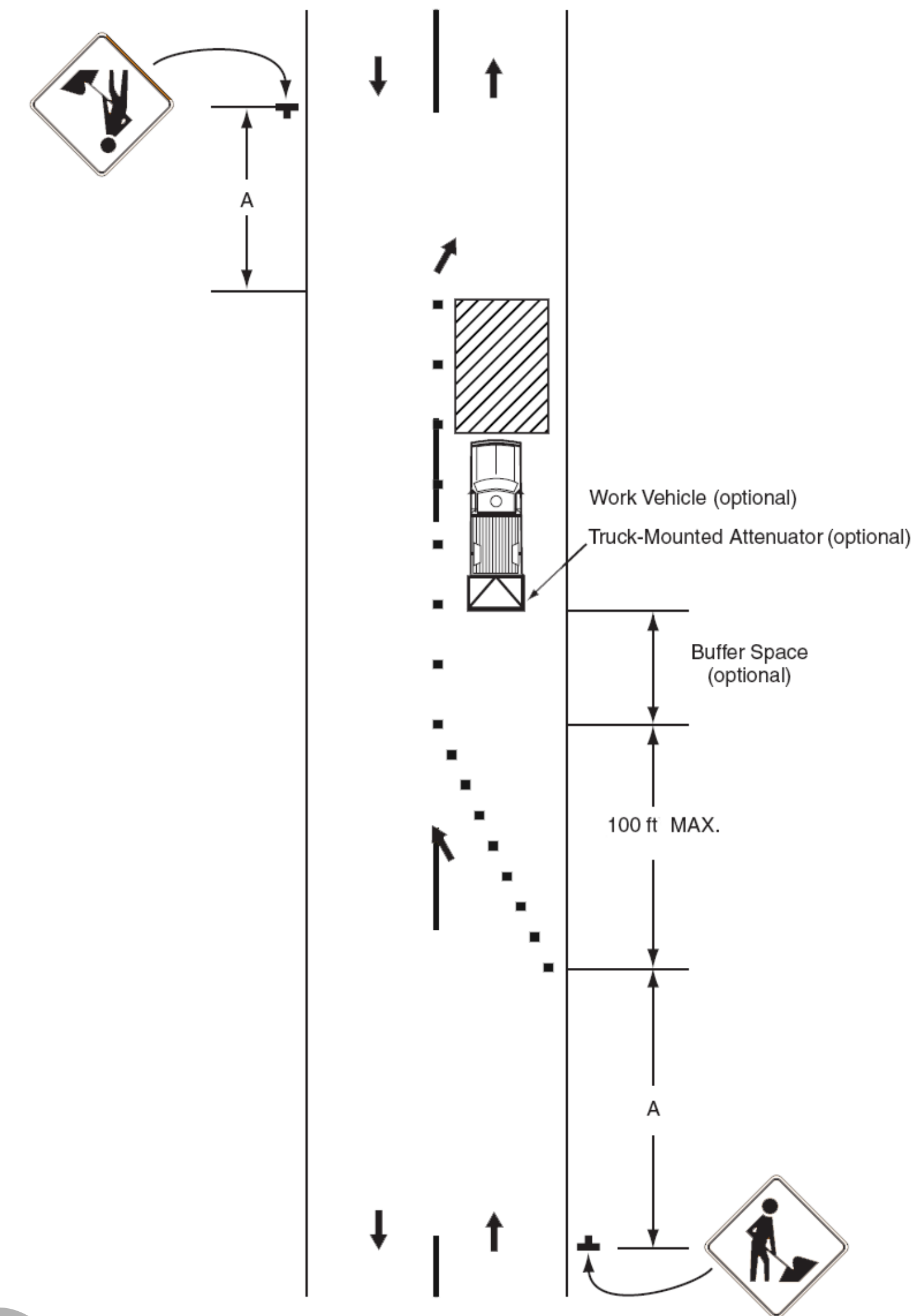
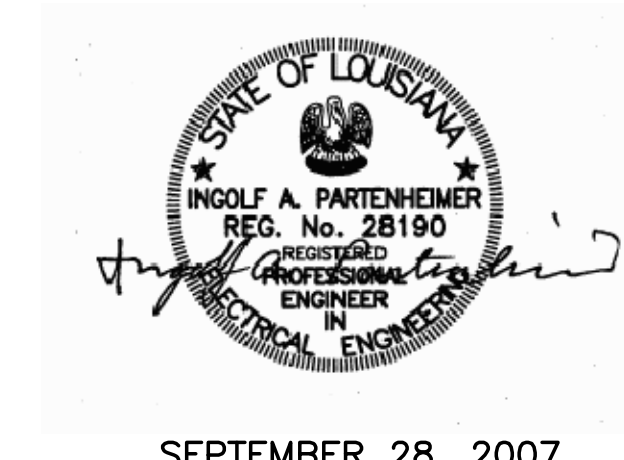

Figure TA-18  
Lane Closure on Minor Street

Notes:

1. This TTC shall be used only for low-speed facilities having low traffic volumes.
2. Where the work space is short, where road users can see the roadway beyond, and where volume is low, vehicular traffic may be self-regulating.
3. Where vehicular traffic cannot effectively self-regulate, one or two flaggers shall be used as illustrated in Figure TA-10.
4. Flashing warning lights and/or flags may be used to call attention to the advance warning signs.
5. A truck-mounted attenuator may be used on the work vehicle and the shadow vehicle.



STANDARD PLAN NO. 905-06	DATED September 28, 2007	SHEET NO. 1 OF 1
-----------------------------	-----------------------------	---------------------

TEMPORARY TRAFFIC CONTROL  
TYPICAL APPLICATIONS

ENGINEERING DIVISION DEPARTMENT OF PUBLIC WORKS CITY OF BATON ROUGE & PARISH OF EAST BATON ROUGE			
DESIGNED	DRAWN	CHECKED	APPROVED
MUTCD	G. CHENG	B. HARMON	I. PARTENHEIMER

8/6/10	STANDARD PLAN NO. & NOTES REVISION.	G. C.
DATE	DESCRIPTION	BY
	REVISIONS	